

S T A R T E R M O T O R S

T Y P E	AZD	AZE	AZF	AZG	AZJ
----------------	-----	-----	-----	-----	-----



STARTER MOTORS WITH REDUCTION GEAR

APPLICATIONS

Diesel engines of 2 to 6 litre displacement.

FEATURES

- High specific power output and efficiency.
- Excellent cold crank capability with low current drain from battery.
- Reduced weight and dimensions in comparison to direct drive starter motors.
- Highly efficient drive assembly for idle run of the pinion.

DESIGN

Nose or noseless versions for specific applications on the engine.

Rubber shock absorber, low-noise, iron planetary reduction gear using a coaxial pinion with an armature.

Pinion shift mechanism with solenoid, fork lever and helix.

Solenoid switch with pull-in and hold-in winding and double return spring for effective breaking of the main contacts.

Six-roller clutch and drive assembly is designed to transmit power from the starter motor to the engine.

High quality thermal resistant materials.

Support brackets of grey cast iron (GCI), modular cast iron (NCI) or die cast aluminium (DCA).

Free of asbestos, cadmium, beryllium and ammonia.

Additional dust protection is available with lip seal on the pinion.

Water protection is achieved using drain holes, O-rings and a rubber boot.

Oil-proof versions for wet clutch applications.

Insulated return versions are available.

MAIN TECHNICAL DATA

Type	AZE41 / AZE45...- nose / AZE46...- noseless	
Nominal voltage (V)	12V	24V
Rated power (kW)	3.2	3.5
Length-nose	< 246	< 246
Length-noseless (mm)	< 274	< 274
Weight-nose	6.5 - 8.3	6.5 - 8.3
Weight-noseless (kg)	6.5 - 8.5	6.5 - 8.5
Yoke diameter (mm)	90	
Stator	4-pole windings	
Drive assembly	6 rollers	
Solenoid 12V	pull-in current < 62 A	
	hold-in current < 14 A	
24V	pull-in current < 30 A	
	hold-in current < 6 A	
Terminals	30 - M8, M10	
	31 - M8	
	50 - M4, M5, M6, 6.4 x 0.8	
Basic protection	Protected against ingress of dust, solid foreign objects and splashing water (IP 56)	
Ambient temperature	- 40°C to + 110°C	

CROSS SECTION

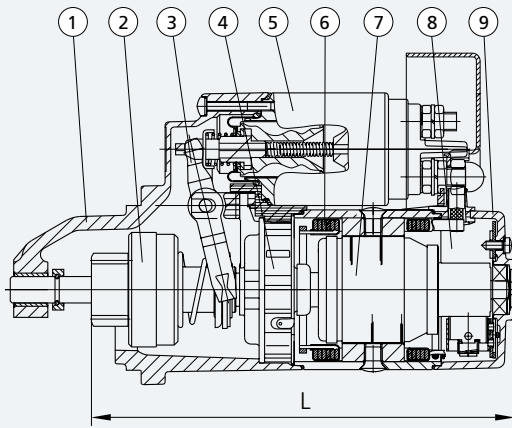

WITH NOSE

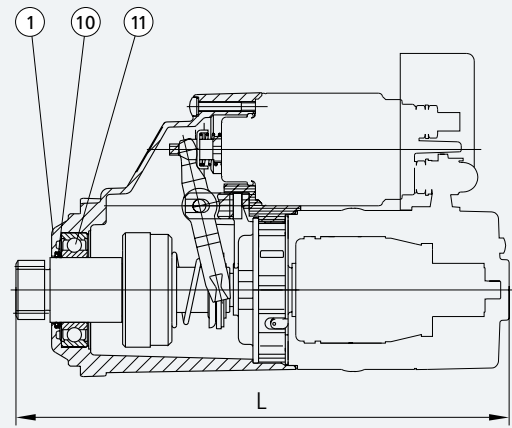

NOSELESS

1. Drive end bracket • 2. Drive assembly • 3. Engaging lever • 4. Reduction gear • 5. Starter switch • 6. Stator
7. Armature • 8. Brush holder • 9. Commutator end bracket • 10. Gasket • 11. Bearing

CONNECTION DIAGRAMS

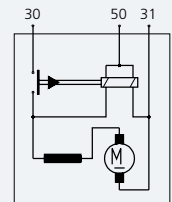
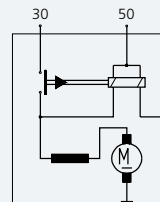

CHARACTERISTICS

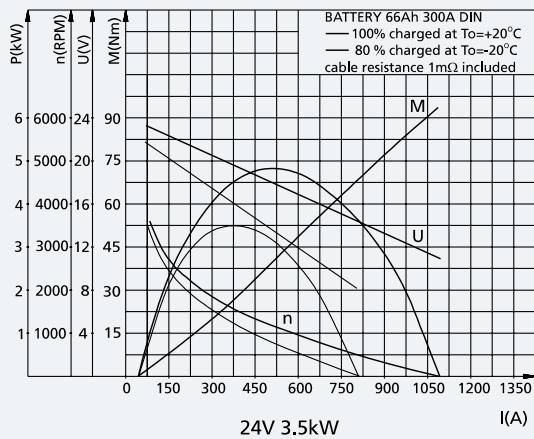
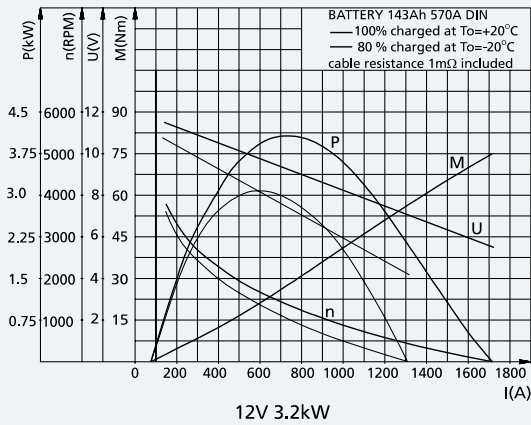

Iskra Avtoelektrika, d. d.

Polje 15, Slovenia,
5290 Šempeter pri Gorici
Tel.: +386 5 33 93 000,
Fax: +386 5 33 93 801
E-mail: info@iskra-ae.com
www.iskra-ae.com

BELARUS

IskRa o. o. o.
Ul. Dombrovskogo 69
230002 Grodno
Tel.: +375 152 487 484
Tel/Fax: +375 152 487 485
E-mail: iskra@mail.grodno.by

BOSNIA AND HERZEGOVINA

Iskra AE Komponente, d. o. o.
Nemanjina 35
78250 Laktaši
Tel.: +387 51 53 07 85
Fax: +387 51 53 53 15
E-mail: iskra-ae@inecco.net

BRAZIL

Iskra do Brasil Ltda.
Rua Testa n. 81 -
Jardim Sao Sebastiao
Jaguariuna - (SP)
CEP 13820-000
Tel.: +55 19 3837 2363
Fax: +55 19 3837 3185
E-mail: uros.kravos@iskra-ae.com
www.iskra-ae.com.br

CHINA

Iskra Suzhou Autoelectric Co., Ltd.
Wenzhou Industrial Zone Shuangfeng
Taicang, Jiangsu Province
Tel: +86 512 8160 6888
Fax: +86 512 8160 7799
E-mail: iskrasuzhou@iskra-ae.com
www.iskra-ae.com.cn

Changchun Fawer
Iskra Automotive Electrical Co., Ltd.
No. 2258 Pudong Road
Changchun Economic
Technology Development Zone
Changchun, Jilin Province
Tel.: +86 431 461 5016
Fax: +86 431 461 5017
E-mail: zhj_fa@faw.com.cn

FRANCE

Iskra Autoelectrique S.A.S.
ZA du Chapeau Rouge
56000 Vannes
Tel.: +33 2 97 45 59 90
Fax: +33 2 97 45 59 99
E-mail: iskra@iskra-sa.fr
www.iskra-ae.fr

GERMANY

Iskra Deutschland GmbH
Danziger Strasse 1
71691 Freiberg am Neckar
Tel.: +49 7141 702 69 0
Fax: +49 7141 702 69 33
E-mail: info@iskra-ae.de
www.iskra-ae.de

GREAT BRITAIN

Iskra UK Ltd.
Redlands
Ullswater Crescent, Coulsdon
Surrey CR5 2HT
Tel.: +44 208 668 7141
Fax: +44 208 668 3108
E-mail: sales@iskra-agency.co.uk
www.iskra-ae.co.uk

IRAN

Iskra Autoelectric Iran JVC
No.28, East Mirdamad Avenue
Tehran 15469-34311
Tel.: +98 21 2 226 237 1 - 4
Fax: +98 21 2 226 237 6
E-mail: info@iskra-iran.com

ITALY

Iskra Autel S. r. l.
Via G. Cantore, 2
34170 Gorizia
Tel.: +39 0481 536 800
Fax: +39 0481 536 810
E-mail: info@iskra-autel.it
www.iskra-autel.it

RUSSIA

Iskra Avtoelektrika
Representative Office
Storozhevaya str., 4,
building 1 office 123
111020 Moscow
Tel.: +7 095 726 93 94
Fax: +7 095 225 84 06
E-mail: info@iskra-ae.ru
www.iskra-ae.ru

Pramo Iskra o.o.o.
Zubcovskoe shosse 21
172387 Rzhev, Tverskaya obl.
Representative office in Moscow
Elektrozavodskaya str. 21
107023 Moscow
Tel. / Fax: +7 495 995 2512
E-mai: iskra@pramo.ru

SPAIN

Iskra Autoelectrique Spain S.A.
Calle Llobatona No. 6-D
08840 Viladecans
Tel.: +34 93 647 40 83
Fax: +34 93 647 40 84
E-mail: iskra@iskra-ae.es
www.iskra-ae.fr/esp/

USA

Iskra AE Inc.
4814 American Road
Rockford, IL 61109
Tel.: +1 800 474 1996
Tel.: +1 815 874 4022
Fax.: +1 815 874 4024
E-mail: iskra@iskraae.com
www.iskraae.com